

FEATURE RECORD

FEATURE NO. 1RECORDER KOCHSITE NO. SA 26-1DATE: 5/3/76LOCATION: excavation unit: TEST PIT Asize & approximate location: 3/4 m. x 1/3 m. = 1/2 m. NW quadrantDepth from surface: top: 8000 59 m From Datum: top: 3 2.10 m
base: 72 m base: 2.23 mDEFINITION: LIGHT BROWN ORANGE
AREA FLECKED WITH CHARCOAL
AND BRICK

ASSOCIATED MATERIAL:

1. Field Specimen nos.: 5
2. Other Features: NONE
3. Other: NONE

MATRIX & STRATIGRAPHY:

ORIGINATES IN LEVEL 4 &
ENDS IN LEVEL 5.SURROUNDED BY LIGHT BROWN
SHELL-FLECKED MIDDENMAP REFERENCE: #2PAGES IN NOTES: 9-10PHOTOGRAPHS: NONE

SKETCH ON REVERSE SIDE

Previous feat. record from dated 5-3-76

FEATURE RECORD

FEATURE NO. 2RECORDER RecSITE NO. SA 26-1DATE 5-18-76LOCATION: excavation unit 106N103E, 103N106Esize & approximate location 1 m. x 5 m.depth from surface: top 33M
43M
base 51MDepth from datum: top 1.97 - 0.9 m
2.70 - 7.0 m
base 2.18DEFINITION: Small cut aquina blocks (cross hatched
stones) w/ fracture of whole oyster shell & lime mortar
Aquina pass is topped by layer of mortar

ASSOCIATED MATERIAL:

MATRIX & STRATIGRAPHY:

originates in level 4. Surrounded by light
brown rubble & shell-flecked midden

- 1) Field Specimen nos.: 17,
- 2) Other Features:
- 3) Other:

MAP REFERENCE: 3, 6, 9PAGES IN NOTES: 14, 15, 16, 5, 66, 53, 5PHOTOGRAPHS: #1, #2,Notes: Photo. at top of aquina
blocks taken exposed under mortar

SKETCH ON REVERSE SIDE

FEATURE RECORD

FEATURE NO. 3

RECORDER Bonath

SITE NO. SA-26-1

DATE: 5-3-76

LOCATION: excavation unit: 106N 106E

size & approximate location: N central

Depth from surface: top; 43m
base: 99m

From Datum: top; 2.07
base: 2.63

DEFINITION: heavy concentration of whole oyster shell, bone, ceramics with a thin layer of light grey clay topping it

ASSOCIATED MATERIAL:

MATRIX & STRATIGRAPHY:

Originates in Level 4 (45-60cm)
4 is adjacent to N wall and to Fea #2 on S. Level 4 soil is light brown shell & rubble flecked.

1. Field Specimen nos.: 16
2. Other Features: Fea. #2
3. Other:

MAP REFERENCE: Map #3

PAGES IN NOTES: 16-17

PHOTOGRAPHS: #3, #4

SKETCH ON REVERSE SIDE

FEATURE RECORD

FEATURE NO. 4

RECORDER Pae

SITE NO. SA-26-1

DATE: 5/18/76

2 1/4 Mile x 1/2 Mile

LOCATION: excavation unit 106N 106E

size & approximate location: in SE Quad of D

Depth from surface: top 0.54
base .85

Depth from datum: top 2.18
base E-2.41/W-2.37

DEFINITION: Taken from top of
whole & crushed oyster shell mixed
with possible heavy rubble

ASSOCIATED MATERIAL:

MATRIX & STRATIGRAPHY:

Area A, D, G, K & C,
Zone 2 Level 4
Area K, I, G, R, F & S

- 1) Field Specimen nos.: 51
- 2) Other Features: Areas A, D, G, K & C
- 3) Other: PITS 7 & 14

MAP REFERENCE: 5

PAGES IN NOTES: p 20

PHOTOGRAPHS:

SKETCH ON REVERSE SIDE

FEATURE RECORD
FEATURE NO. 5

RECORDED Bonath

DATE NO. SA-26-1
DATE 5-7-76

LOCATION: excavation unit D106N103E, size & approximate location 2m x 0.5m, center
depth from surface: top 0.35m depth from datum: top 1.94
base 1.5m base 2.26

DEFINITION: possible wall footing-
oyster shell & mortar mixture
aligned N-S in square
still, based on ground art trench, packed
STRATIGRAPHY: Originates
at base of Zone I - intrusive
into Zone II, Level 1,
adjacent to Feat 2 on S
& runs into N wall

ASSOCIATED MATERIAL:

- 1) Field Specimen nos.: 67
2) Other Features: Feat #2, 6 (unl.)
3) Other:

MAP REFERENCE: 6

PAGES IN NOTES: 36

PHOTOGRAPHS: #1, #2

SKETCH ON REVERSE SIDE

FEATURE RECORD
FEATURE NO. 6

RECORDED Poe

DATE NO. SA-26-1
DATE 5-18-76

LOCATION: excavation unit D106N106E, size & approximate location 2m x 1m NW quad
depth from surface: top 1.1m depth from datum: top 2.20
base 1.04m base Low 2.97
High 2.36

DEFINITION:

Dark grey sandy soil w/ heavy
concentrations of shell & bone

STRATIGRAPHY:

Intersected by Zone II level 2, Feat 2 & 5,
Feat 7.

Below Zone 2 level 2

Not sterile

Normal bag has been contaminated
with material from area D106N103E

SKETCH ON REVERSE SIDE

ASSOCIATED MATERIAL:

- 1) Field Specimen nos.: 60
2) Other Features: Feat. 7
3) Other: 2 & 5

MAP REFERENCE: 6

PAGES IN NOTES: 51

PHOTOGRAPHS:

Two under Tree 2 - new area disclosed

Station 106 N 106 E
Depth from surface: 106 N 106 E
Partial F-ES 194

Station 106 N 106 E
Depth from surface: 106 N 106 E
Partial F-ES 194

Station 106 N 106 E
Depth from surface: 106 N 106 E
Partial F-ES 194

Station 106 N 106 E
Depth from surface: 106 N 106 E
Partial F-ES 194

Station 106 N 106 E

Station 106 N 106 E
Depth from surface: 106 N 106 E
Partial F-ES 194

Station 106 N 106 E
Depth from surface: 106 N 106 E
Partial F-ES 194

Station 106 N 106 E
Depth from surface: 106 N 106 E
Partial F-ES 194

Station 106 N 106 E
Depth from surface: 106 N 106 E
Partial F-ES 194

Station 106 N 106 E
Depth from surface: 106 N 106 E
Partial F-ES 194

Station 106 N 106 E
Depth from surface: 106 N 106 E
Partial F-ES 194

Station 106 N 106 E
Depth from surface: 106 N 106 E
Partial F-ES 194

Station 106 N 106 E
Depth from surface: 106 N 106 E
Partial F-ES 194

SITE NO. 9 RECORDER Singleton SITE NO. 26-1
 DATE May 20, 1976
 LOCATION: excavation unit D103N 106E size - see sketch & location L16 pg. 1-3
 depth from surface: top 51 M length from center: top 2.10
 base _____ base _____
 DEFINITION: 19th cent. Trash pit ASSOCIATED FEATURES:

MATRIX & STRATIGRAPHY: initiates near
 the base of zone I (.04 m) above
 zone II. Matrix + Top of zone
 2 toward east and Coquina
 rubble to the south.

(1) FIELD SECTION NOS.: FS 70 - 400
 (2) OTHER FEATURES: FS 80 - UNDERWAY
 (3) OTHER:
 MAP LOCATION: Map 9
 PAGE IN VOL. NO: p. 71
 PHOTOGRAPH OF:

LIST OF EXCAVATION UNITS

FEATURE DESIGN NO. 10 RECORDER Singleton SITE NO. 26-1
 DATE May 20, 1976
 LOCATION: excavation unit D106N 103E size - see sketch & location
 depth from surface: top .83 M length from center: top 1.31
 base _____ base _____
 DEFINITION: area of grey-
 brown shell-flecked soil
 Trash pit

MATRIX & STRATIGRAPHY:
 initiates at base of zone II
 level II in a leached
 zone. Intrudes into level

(1) FIELD SECTION NOS.:
 (2) OTHER FEATURES: Fea 2
 (3) OTHER:
 MAP LOCATION: 6
 PAGE IN VOL. NO: 72
 PHOTOGRAPH OF: None

SECTION 11

EXPOSURE BOSTWICK

SA-26-1
26 MAY 76

LOCATION: excavation unit 103N 91E

size & approximate location S 1/4 OF SQ

depth from surface: top 25
base

depth from datum: top 1.79
base

DEFINITION: MASONARY COQUINA
STRUCTURE - 3 COINTE

ASSOCIATED FACILITIES: possibly Fur 2
in D'A 106N106E, 106N103E

UNITS & STRATIGRAPHY: extends from
limestone to sterile soil

- 1) Field Specimen nos.: none
2) Other Features:
3) Other:

MAP INDICATION: 10, SR# 4

PAGES IN NOTES: 79

PHOTOGRAPHED: 2 - color

SECTION ON REVERSE SIDE

SECTION 12

EXPOSURE BOSTWICK

SA-26-1
26 MAY 76

103N 91E

NE 1/4 OF SQ

90

141

237

288

Dark gray rubble &
shell flecked pit

PIT A, PIT B,
PIT C, PIT D

STRATIGRAPHY: continues into
sterile zone

Excavation suspended at
water table. Well points
needed to complete excavation
of this feature

- 1) Field Specimen nos.: 90

2) Other Features:

3) Other:

MAP INDICATION: 10

PAGES IN NOTES: 78, 79

PHOTOGRAPHED:

THOMAS/103

PAGES IN TOTAL: 91

MAP 11

3) OTHER:

2) OTHER FEATURES:

1) FIELD SHEET NO.:

*Intermittent little
holes again with*

1/2 inch deep, small, shallow

depth from surface: top 89

excavation unit 103N 106E

PROCESSED BY: *[Signature]*

DATE: 1/4

depth from surface: top 237

excavation unit 103N 106E

DATE: 5-26-1
TIME: 2:15 PM

THOMAS/103

PAGES IN TOTAL: 81+82

MAP 6

3) OTHER:

2) OTHER FEATURES: (see 8) notes

1) FIELD SHEET NO.:

*below sea. 2 + Zone II, 101. II,
surrounded by sea. 8 + bulk.*

*dark brown
trash pit*

depth from surface: top 245

excavation unit 106N 103E

PROCESSED BY: *FOLENS BEE*

DATE: 1/3

depth from surface: top 245

excavation unit 106N 103E

DATE: 5-27-74
TIME: 5:06 PM

1000000000

MAP NUMBER: Map 12
PAGE IN BOOK: 103, 104

- 1) FIELD SPECIES NOS.:
- 2) OTHER FEATURES:
- 3) OTHER:

ASSOCIATED MATERIAL:

Basal of Zone I - below
modern building rubble
Cognitive block and
little compact on
E half of S wall
MATRIX & STRATIGRAPHY:

DETERMINATION:

depth from surface: top 1.94m
base

depth from surface: top 1.94m
base

size & approximate location E half of S wall

LOCATION: excavation unit B103N103E

PLANT RECORD

PLANT NO. 16

PROJECT Almon

DATE 5/26/76
TIME 6/23/76

1000000000

PAGES IN BOOK: 100 - 101

MAP NUMBER: 10

- 1) FIELD SPECIES NOS.:
- 2) OTHER FEATURES: Pit E + Fa 15
- 3) OTHER:

ASSOCIATED MATERIAL:

Underlies feature 11 &
infrudes into sterile

MATRIX & STRATIGRAPHY:

Pit E and feature 15
dark grey charcoal
+ cell-flecked semi-circular pit

DETERMINATION:

depth from surface: top 2.30
base 5.49

depth from surface: top 2.30
base 5.49

size & approximate location SE corner of 1/2 lot ca. 75'

LOCATION: excavation unit 91N103E

PLANT RECORD

PLANT NO. 15

PROJECT Binley

DATE 22 JUN 76
TIME 5/26-1

FEATURE RECORD
FEATURE NO. 17

RECORDED Kathy Sedra

SITE NO. SA-1
DATE June 24, 1971

LOCATION: excavation unit II 100N 94E, size & approximate location 2m along E

depth from surface: top .06
base .46

depth from datum: top 1.68
base 1.94

DEFINITION: probable coquina block wall
75#136 - material with coquina well itself
material under wall will be bagged separately w/ its own 75 #.

ASSOCIATED MATERIAL:

MATRIX & STRATIGRAPHY: within zone I, intruding into
zone II level

- 1) Field Specimen nos.: 136
2) Other Features:
3) Other:

MAP REFERENCE: 13

PAGES IN NOTES: 108-109, 121-123

PHOTOGRAPHS: #20

FEATURE RECORD
FEATURE NO. 18

RECORDED Kathy Sedra

SITE NO. SA-26-1
DATE June 24, 1971

LOCATION: excavation unit II 100N 94E, size & approximate location NW 3.4.2

depth from surface: top .44
base

depth from datum: top 1.99
base 2.41 (level I)
3.38 (level 2)

DEFINITION: irregular L shaped area
of yellow, grey, and brown mottled

ASSOCIATED MATERIAL: post hole B intrudes

NEW EXTENT- ALONG SWALL TO SE CORNER

MATRIX & STRATIGRAPHY: intruding from zone I
to zone II level

- 1) Field Specimen nos.: 147, 148-149
2) Other Features: INTRUDED ON
PH. B; FEATURES 17 & 19 AND
3) Other: POSSIBLY 22 ITSELF
is intruded on by zone 2
level, but 4 - see 5 1/2

MAP REFERENCE: 13, 17

PAGES IN NOTES: 108-109, 126-127

PHOTOGRAPHS:

Feature 18 closed out 7/16/71 when
13 bags of material recovered
since it is a 19th century feature
& time is running out - recovery will
stop. Closed prematurely.

FIELD NO. 5A-26-1

PICTURE NO. 19

RECORDED

K. Linn

DATE

June 24, 1976LOCATION: excavation unit 1100 N 94 Esize & approximate location along W walldepth from surface: top 4.5depth from datum: top W 2.0

base

base

see back of page- see back of page

DEFINITION:

dark gray possible trench.
 L shaped in NW walls.
 Junction in NW cor. of \square

ASSOCIATED MATERIAL:

~~pot sherds~~

MATRIX & STRATIGRAPHY:

~~Dark gray possible~~
~~stone~~

intruders from zone
 I to zone II level

- see reverse page[11] Field Specimen nos.: 130, Level I133, Level II

2) Other Features:

3) Other:

MAP REFERENCE: 13PAGES IN NOTES: 108-109

PHOTOGRAPHS:

SKETCH ON REVERSE SIDE

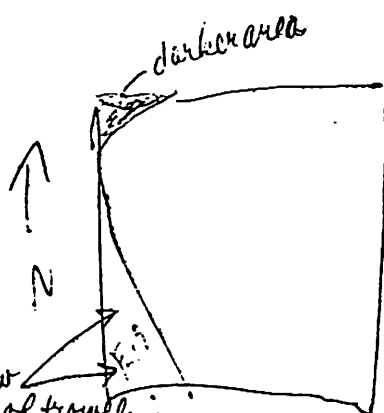

after a few
 centimeters of travelling
 this part of feature 19

disappeared (S. part of W. wall)

Closure of Fea 19: Base in variable in different
 portions of fea; at S end of W arm 2.49,
 W arm 2.38, at center of W arm 2.58

Fea 19 removed in 2 levels: Level I - top to 2.37 M.B.D.

Level II - 2.37 to base FS

Fea 19 now appears after excavation to have been 3 separate pits - Unfortunately combined into 2 FS's

at lower level of feature 19,
 colonial material was abundant; while
 in upper level later material was
 present; therefore, Level I of feature
 F was arbitrarily closed &
 assigned F.S. # 130

Level I of feature 19:

top 1.97Base in W. leg 2.43Base in N. leg 2.37

Level II will be

2.37 M.B.D

to

base of feature

Map 9

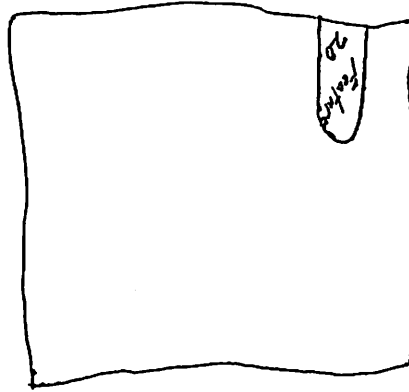

103N
106E



112

9

Other:

Other Features: PH K in base

Field Specimen nos.: 120

Associated Material:

base 2.60

top 2.57

Depth from surface: top 1.02 base 1.05

Excavation with D102 N106E, size of approximate location

5A 26.1
28 June 1976

R. Johnson
J. M. M. M.

Section No. 20

Agree 3, below feature 2
appears to have been a shallow linear
of dark soil rather than a significant
cultural feature
in SE corner of section 20 at base pass.
post hole PH K

note - feature 23, after excavation
appears as only a lens of
lighter colored soil

APPROX AT TOP OF ZONE 3

TO SIX : STRATIGRAPHY:

OF THINNING: IRREGULAR LIGHT BROWN
WHOLE SHELL FRACTURED SAND ALONG
NE SIDE OF D
CENTRE

depth from surface: top
base

EXCAVATION unit D103N103E

depth from datum: top 2.62
base 2.36

26-1
7/1/36

Horton

SECTION ON STRATIGRAPHY

PHOTOGRAPH

MAP SHEET NO. 12
PAGES 11-13

begin at top of Zone 2 fault 1
after separation, very regular
and bottom cut in middle of
after then plane a good feature

TO SIX : STRATIGRAPHY:

irregular crack of dark gray
compact soil

ASSOCIATED MATERIAL:

depth from surface: top 0.66
base 0.87

depth from datum: top 2.25
base 2.46

EXCAVATION: excavation unit D103N103E

26-1
29/Jan/1976

Handwritten signature

22

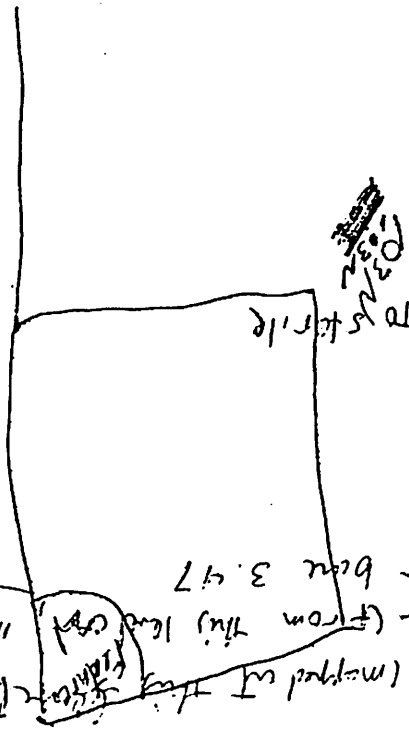

Year	Area (ha)	Yield (kg/ha)	Total (kg)
1957	30.40	40.50	1241.4
1958	45.15	50.60	2285.4
1959	11.15	70.70	787.8
1960	11.16	80.90	904.2
1961	11.16	90.70	1012.2
1962	11.16	100.00	1116.0
1963	11.16	110.00	1227.6
1964	11.16	120.00	1339.2
1965	11.16	130.00	1450.8
1966	11.16	140.00	1562.4
1967	11.16	150.00	1674.0
1968	11.16	160.00	1787.2
1969	11.16	170.00	1897.2
1970	11.16	180.00	2006.4
1971	11.16	190.00	2116.8
1972	11.16	200.00	2227.2
1973	11.16	210.00	2337.6
1974	11.16	220.00	2448.0

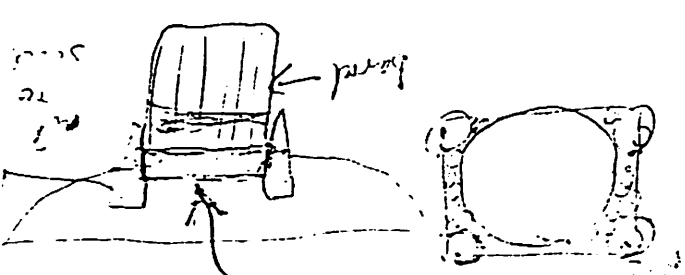

12

Feature is stratified in 10 cm levels in west it is a well. Each 10 cm level gets a different FS # feature appears to be a fair amount on map that

(ii)	Field treatment plot:	
(i)	Other Treatment plots	for seed - and control plot
(i)	Treatment:	20-30cm

Level 1 FS# 12	8-16 cm
Level 2 FS# 11	10-28 cm

circulus over of dark gray
compact soil - little
at base of Zone 2 level!
(part of core and feature
intrude)

LOCATION: 21
EXCAVATION UNIT: ~~103N~~ 103E
DATE OF EXCAVATION: 29 June 1976
SA-26-1
DEPTH FROM SURFACE: top 0.66 m
base 2.74 m
DEPTH FROM DATUM: top 2.26
base 4.90
LOCATION: 21
EXCAVATION UNIT: ~~103N~~ 103E
DATE OF EXCAVATION: 29 June 1976
SA-26-1
DEPTH FROM SURFACE: top 0.66 m
base 2.74 m
DEPTH FROM DATUM: top 2.26
base 4.90

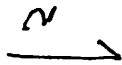

137-128

MAP SHEET # 17

Induced into Zone II, Level III
 1/2 way into Zone II

164

put by black soil @ heavy yellow
 cut with concentration

2.43
 2.98

excavation with 1000 54E

PERRY

54-26-1
 9/12/76